

**INSTRUCTIONS PHOTO ETCHED DETAILS FOR
BRONCO CB35053
TYPE: XXVII B 1/35 SEEHUND**

Description of parts PE

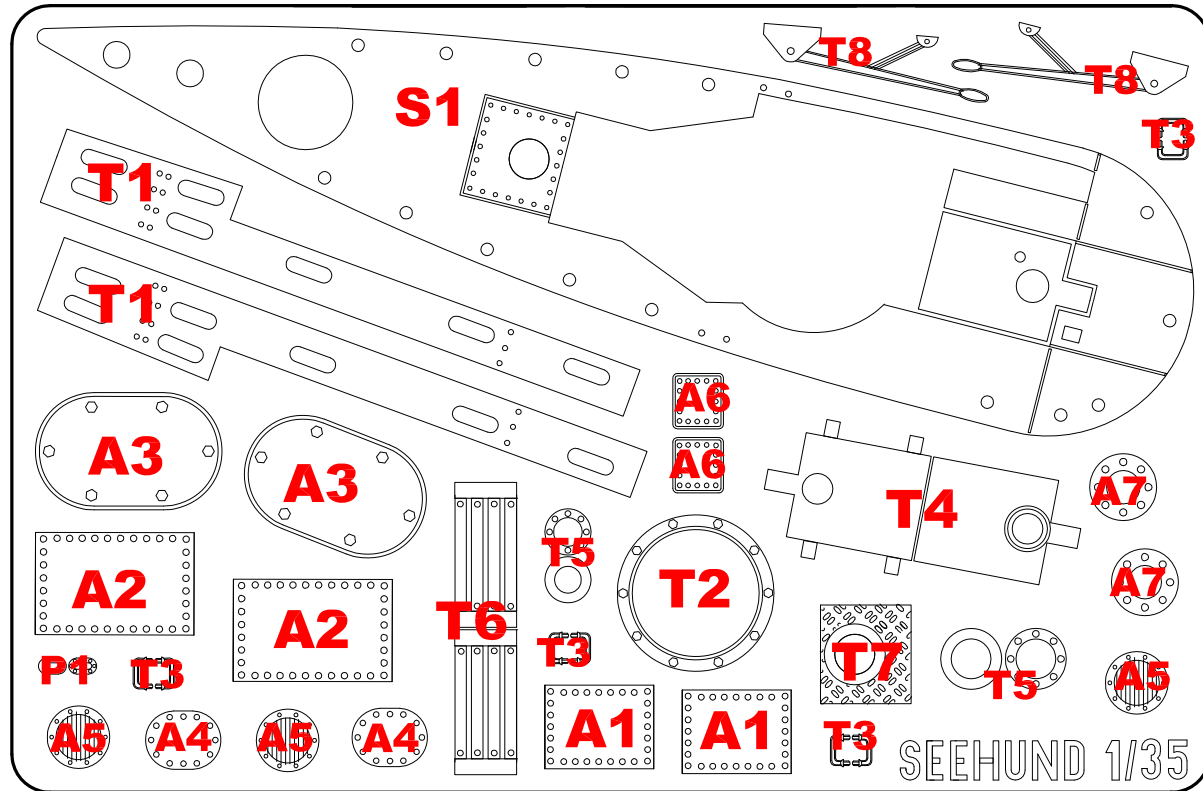

Hull -forming etchings

For a better shaping of etching, it is necessary to heat up plate and then rapidly cool down. etching is soft and well shaped according to the shape of the hull.

Recommendation: Try these steps to shape a different part of the sheet (the rest).

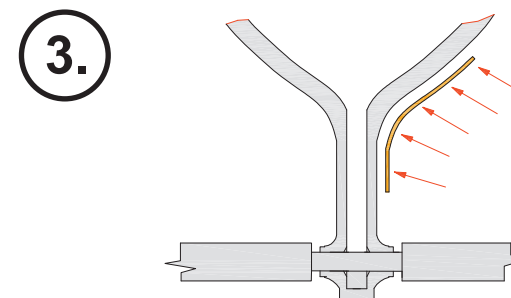
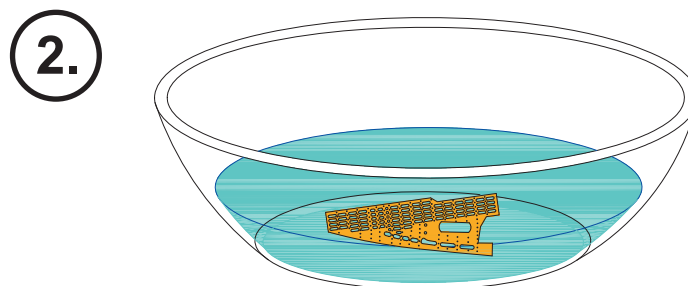
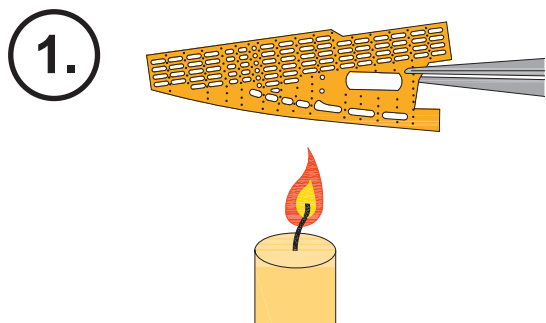

1. fine melting to determine the outline etching (using solder)

2. formation of holes using a milling machine

3. melting etching into the hull

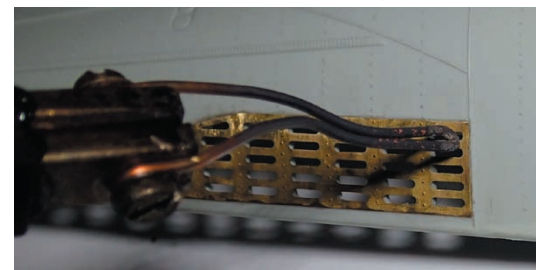
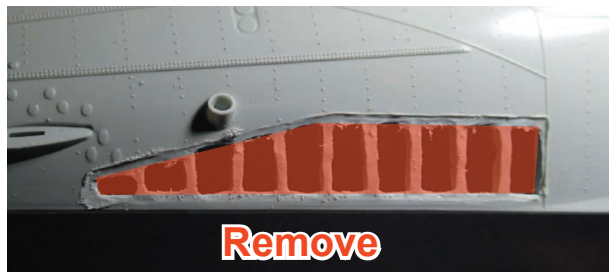
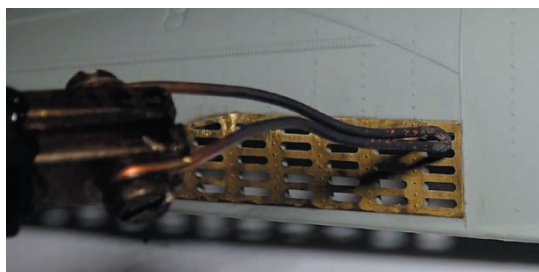

4. gluing and kiting

